

Landseer Road

Hove





We know just the place...



This charming 4-bedroom terraced house is located in central Hove. South facing, the property is warm and bright with contemporary design throughout. Landseer Road is just a few minutes' walk from picturesque Hove Park, Waitrose and Hove Station.

As you enter, the hallway allows access to all ground floor rooms. The entrance is fitted with ample clever storage space and original hardwood flooring; features that continue throughout the property. The spacious reception room is south facing, and as a result, is wonderfully bright. It features a welcoming log burner as well as a preserved early-twentieth-century fire surround, striking a harmonious balance between period characteristics and modern living. It also has access to the good-sized, easy to maintain garden. To the rear of the property is the large modern kitchen/dining room with underfloor heating. The room has been beautifully designed and includes abundant storage space, plus spectacular bi-folding doors leading out into the garden.

On the first floor, there are three good-sized bedrooms and a lovely family bathroom. At the front of the property is the delightful master bedroom. Thanks to a large bay window, the room is light and spacious. The bathroom has been beautifully designed, featuring a walk-in shower and luxurious roll-top bath. The property also features a well-designed loft conversion with bespoke built-in storage and en-suite bathroom. Fitted with two large front Velux windows and two rear sash windows, the room is open, spacious and bright.

The property is set on a wonderfully quiet one-way street in central Hove. A wide range of amenities are only moments away, with George Street and Portland Road both within walking distance. Hove and Aldrington Stations are easy to access, excellent for anyone commuting to London



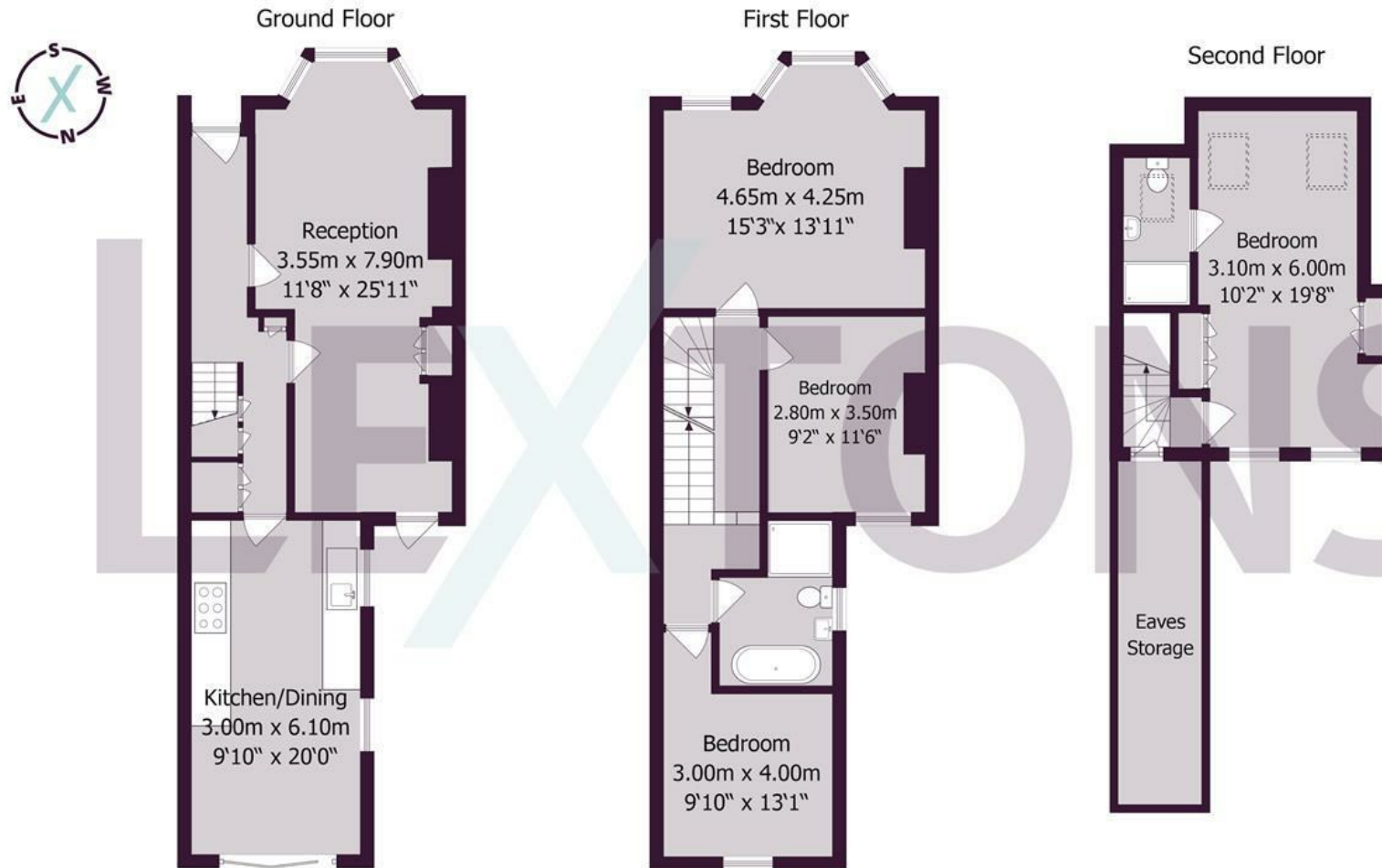

Approximate gross internal floor area 130.5 sq m/ 1405 sq ft

Whilst every care has been taken to ensure accuracy, dimensions are approximate and for illustrative purposes only.

Created by Property Photography UK for Lextons. All rights reserved.

Meet us here...
174 Church Road
Hove
BN3 2DJ

We aim to make our particulars both accurate and reliable. However they are not guaranteed; nor do they form part of an offer or contract. If you require clarification on any points then please contact us, especially if you're traveling some distance to view. Please note that appliances and heating systems have not been tested and therefore no warranties can be given as to their good working order.